

OPENCOMM C102

User Guide

Contents

HOW IT WORKS

Headset Controls	04
ON/OFF	05
Pairing	06
NFC Pairing	07
How to Wear	09
Volume	10
Mute the Microphone	11
Multifunction Button	13
Check Battery Status	14

EXTRA FEATURES

EQ Modes	16
Switching EQ modes	17
Multipoint Pairing	18
Turn Multipoint Pairing Off	24
Restore Factory Settings	26
Changing languages	28

CARE AND MAINTENANCE

Charging Tips	31
Moisture Detection Alert	32
Storage and Maintenance	33

Warranty 34

TROUBLESHOOTING 35

WHAT'S IN THE BOX 36

REGULATORY AND LEGAL INFORMATION
..... 37

How It Works

Headset Controls

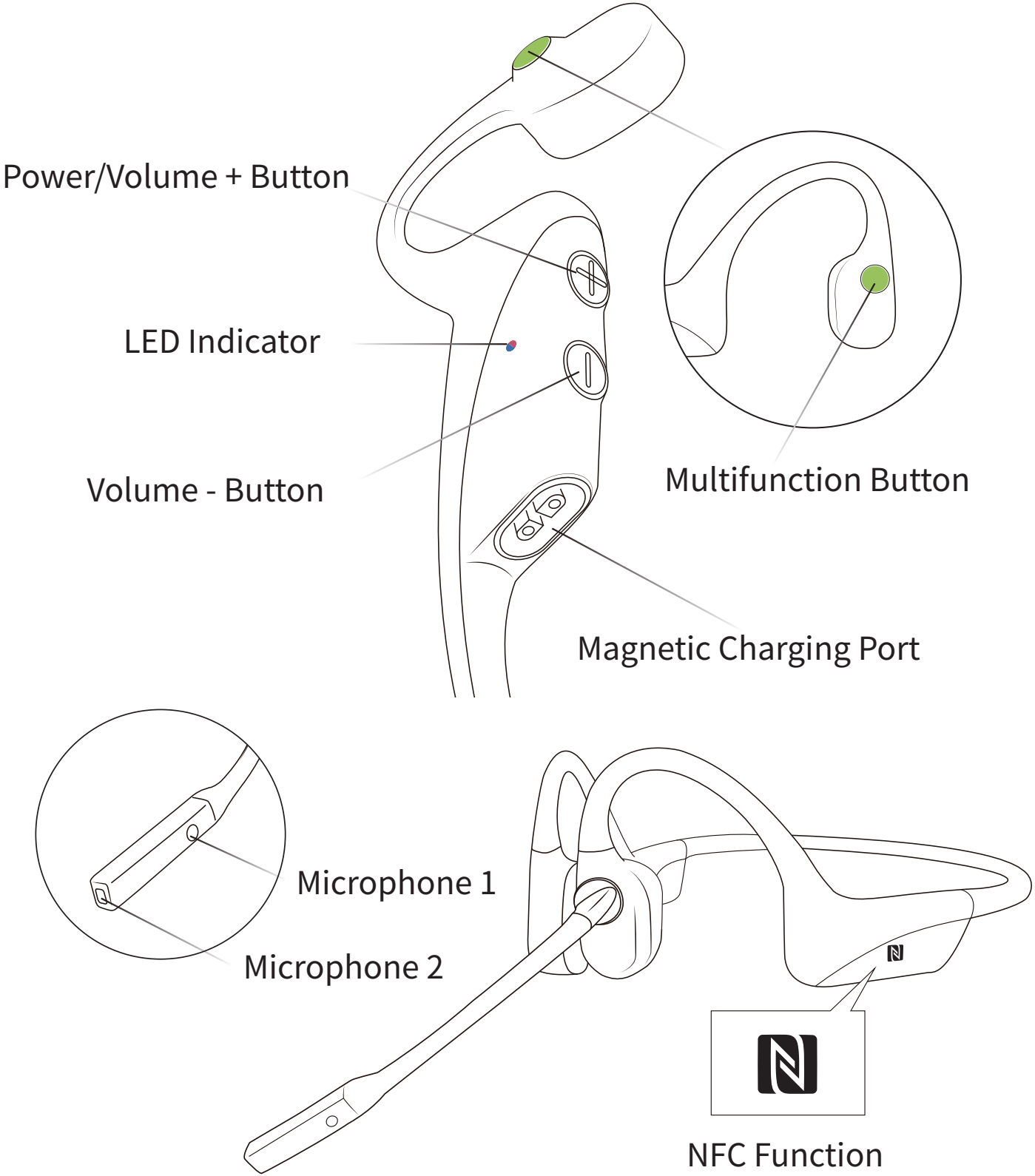

ON/OFF

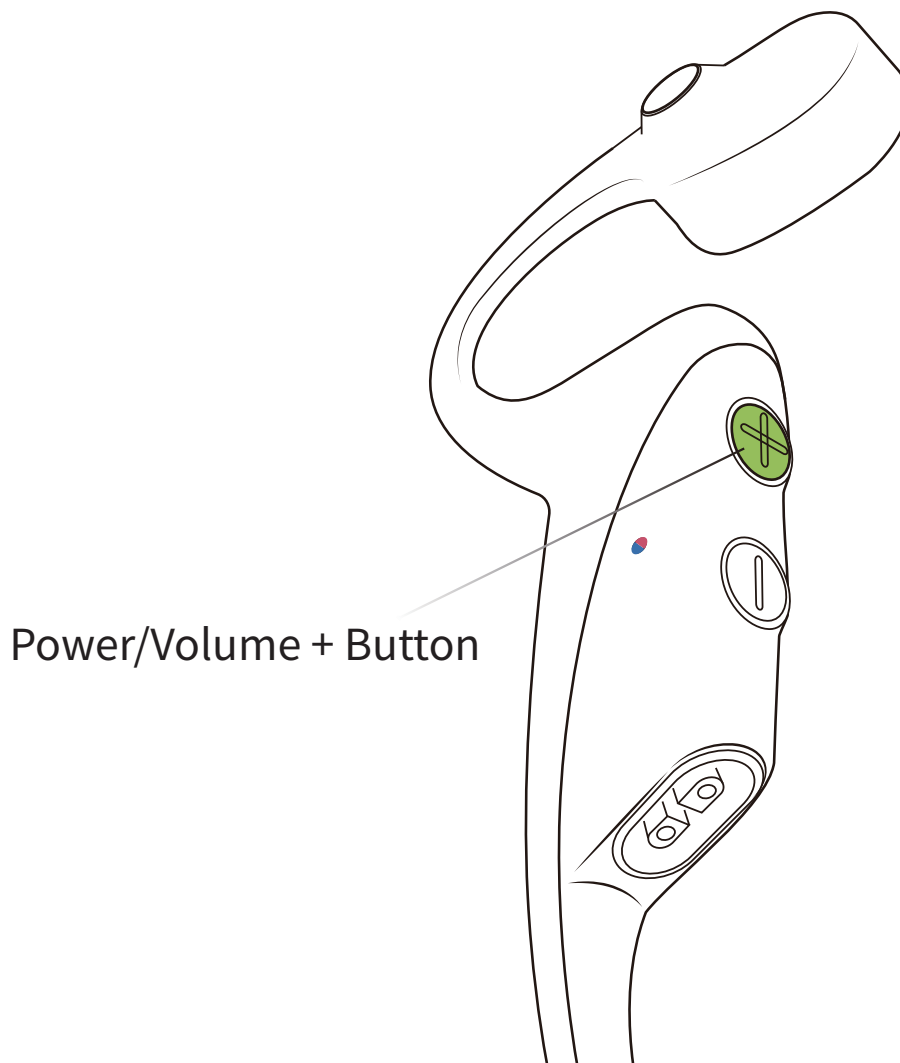

Power/Volume + Button

Turn on the headset:

Press and hold the Power/Volume + Button until the LED Indicator flashes blue.

*Audrey will say: “Welcome to Shokz”

Turn off the headset:

Press and hold the Power/Volume + Button until the LED Indicator flashes red.

*Audrey will say: “Power off”。

Pairing

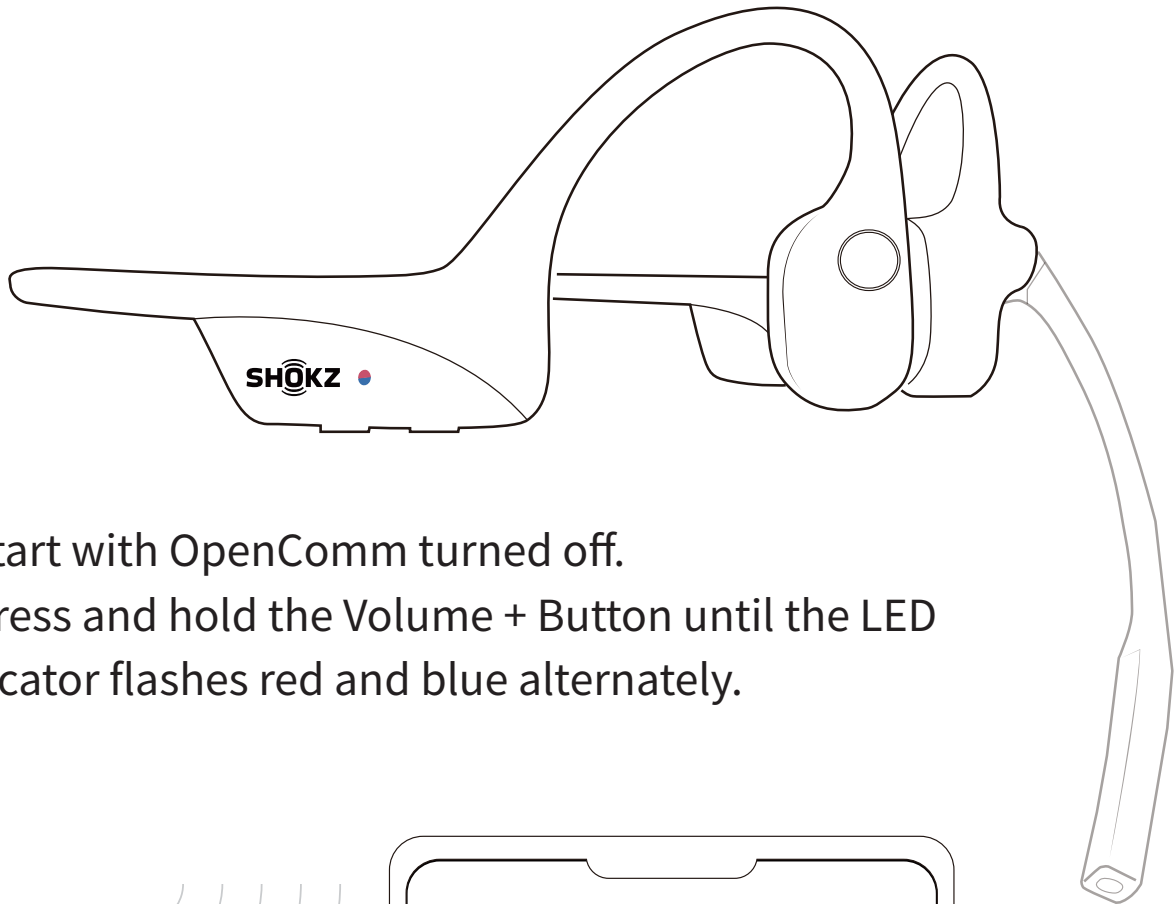

1. Start with OpenComm turned off.
2. Press and hold the Volume + Button until the LED Indicator flashes red and blue alternately.

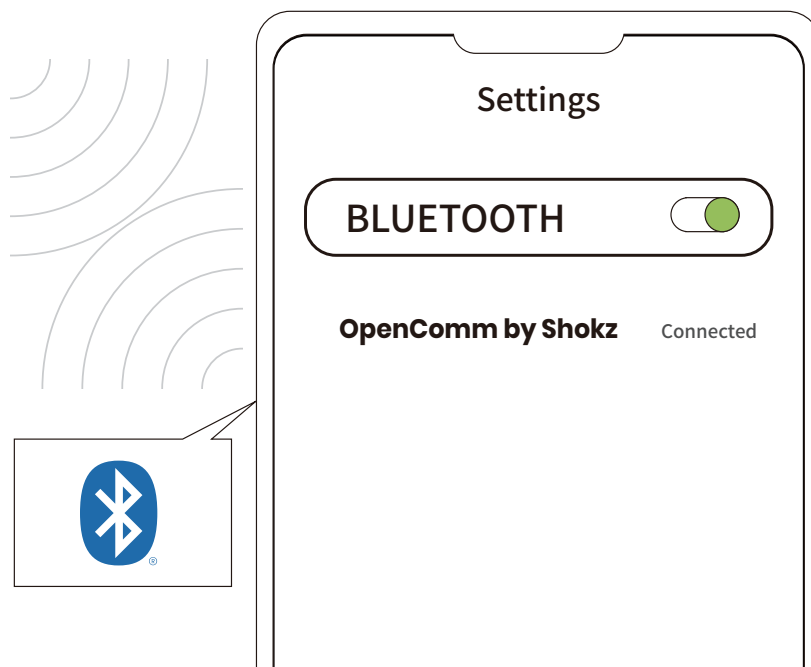

3. Open your device's Bluetooth settings and select "OpenComm by Shokz." Audrey will say "connected."

NFC Pairing

- OFF** Operate controls with headset powered off.

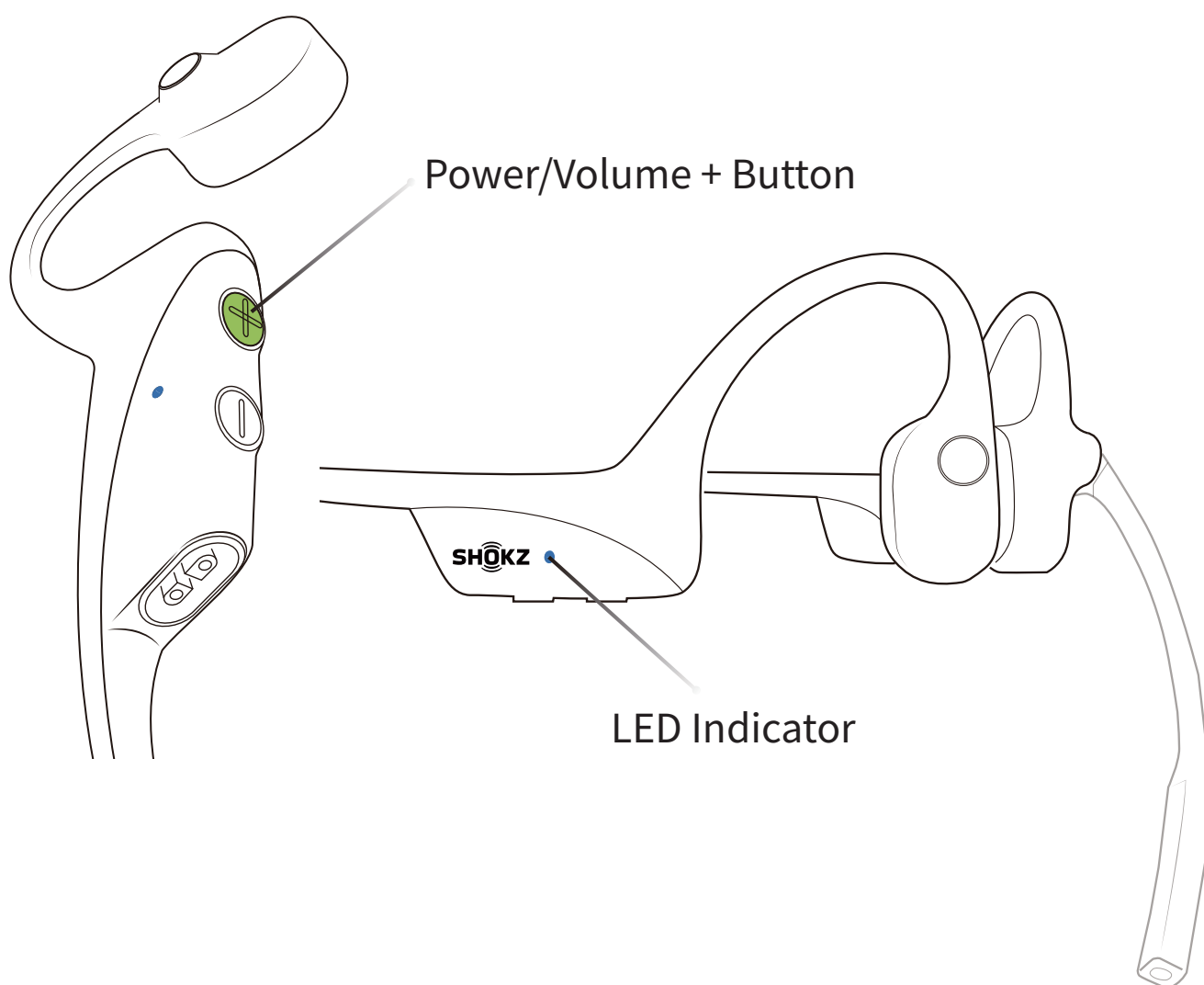

1. Power on your headset (press and hold Power/Volume+ until LED Indicator flashes blue)

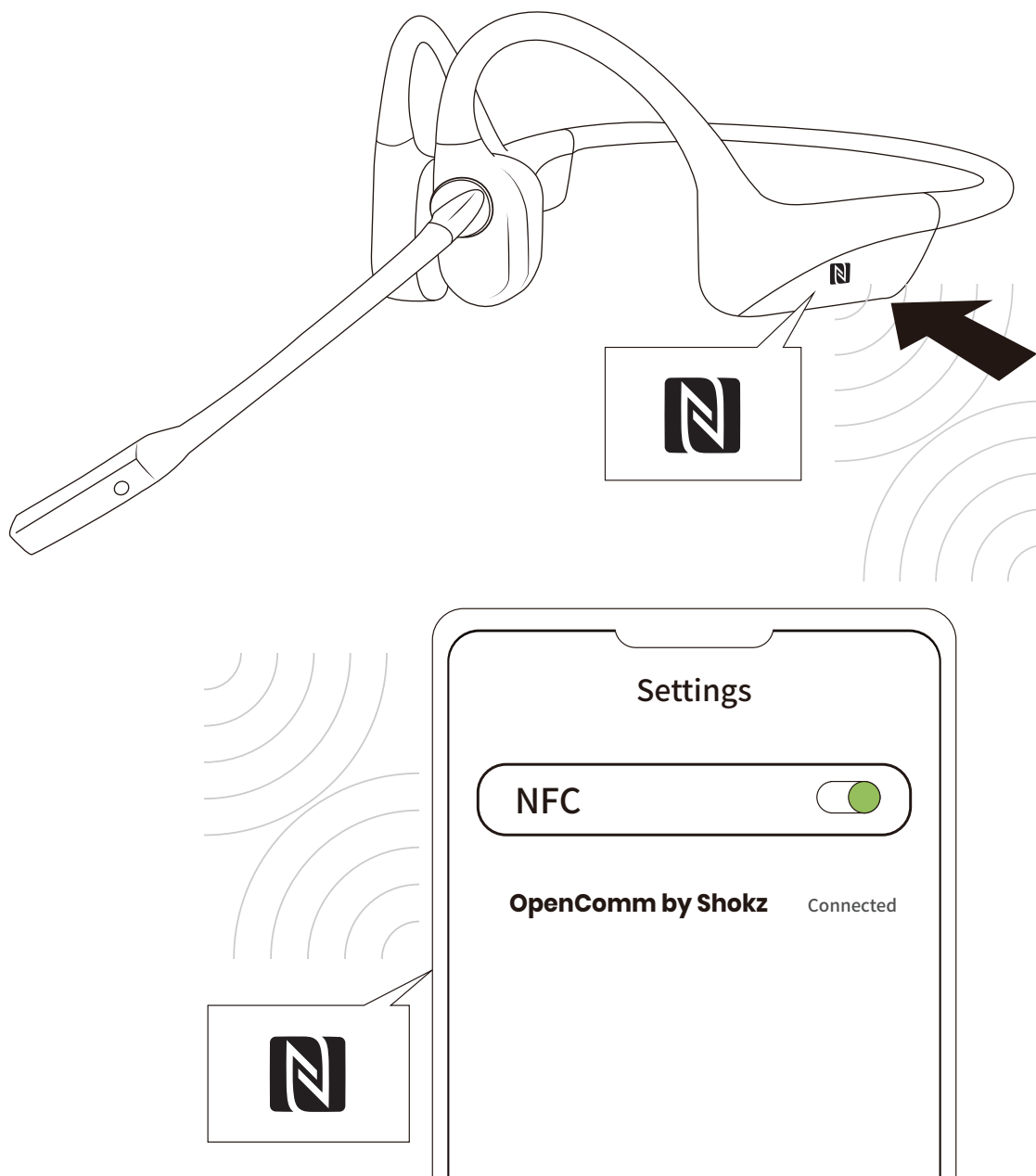

2. Unlock your phone and turn on NFC pairing (Refer to your phone's user guide if needed).
3. Position the headset's NFC logo near the NFC detection area of your phone until the device shows pairing is completed. The headset's LED Indicator will flash blue once when pairing is successful.

How to Wear

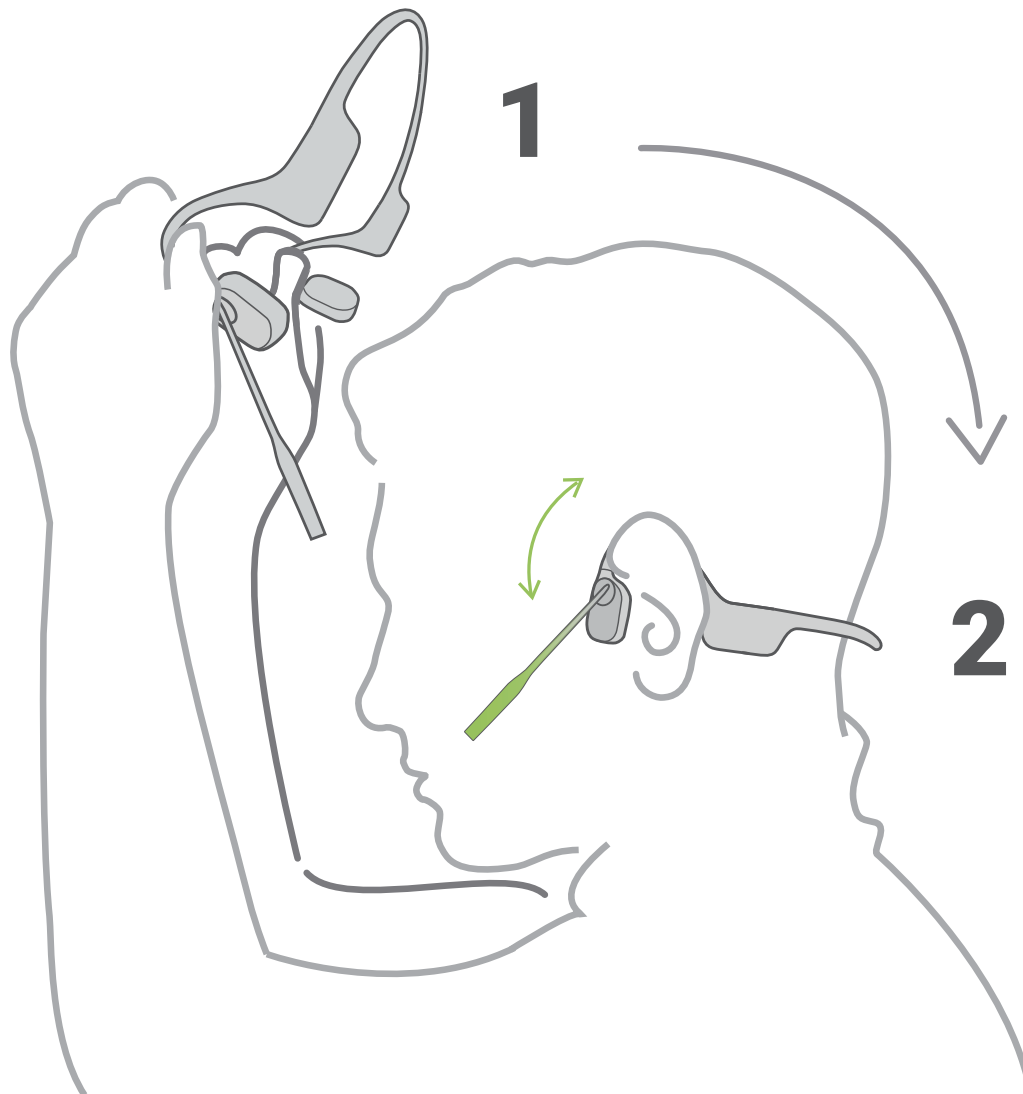

Pick up the headset, bring them behind the back of the base of your neck, position the earhooks on your ears.

*Position the noise-canceling microphone close to your mouth.

*Wearing your headset the wrong way could cause discomfort. The transducers should rest in front of your ears.

Volume



Operate volume controls while audio is playing.

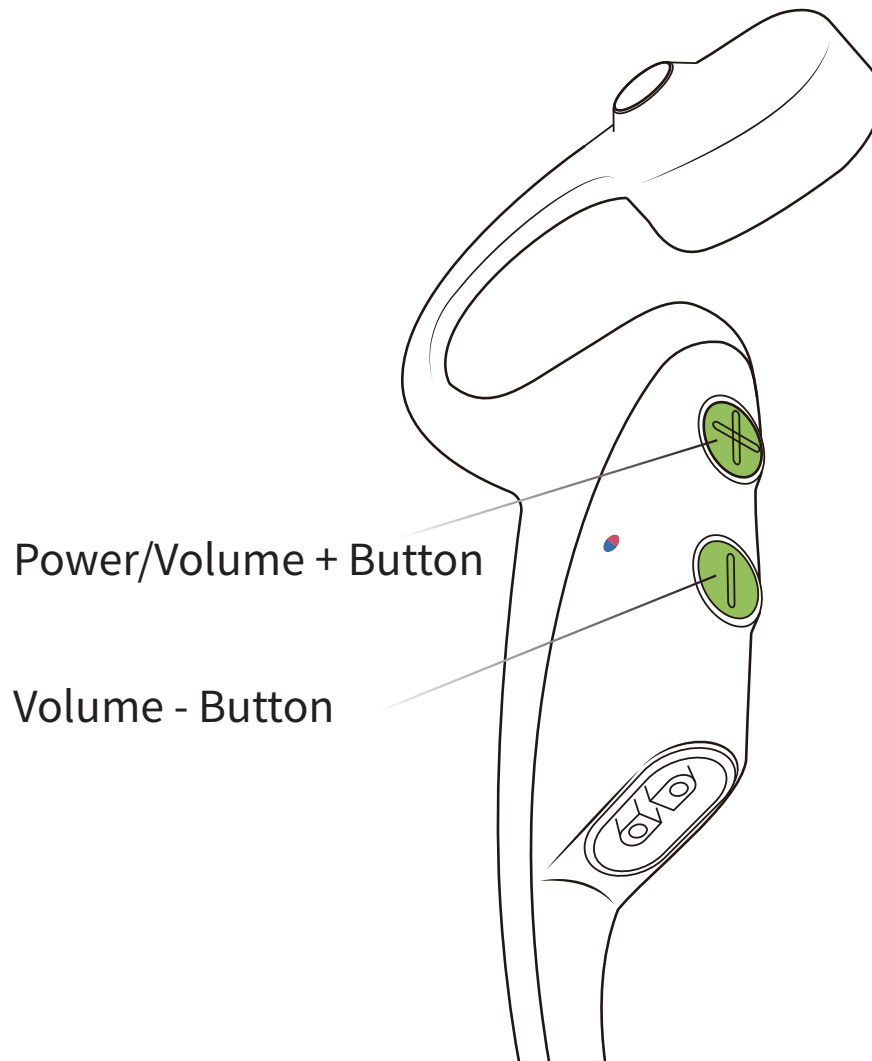

How to change volume:

While your audio is playing, adjust headset volume by pushing either the Volume + or Volume - buttons.

*A “beep” will sound when the volume is at its max.



*Listening with headset at high volume may affect your hearing and the audio will be distorted.

Mute the Microphone



During a call

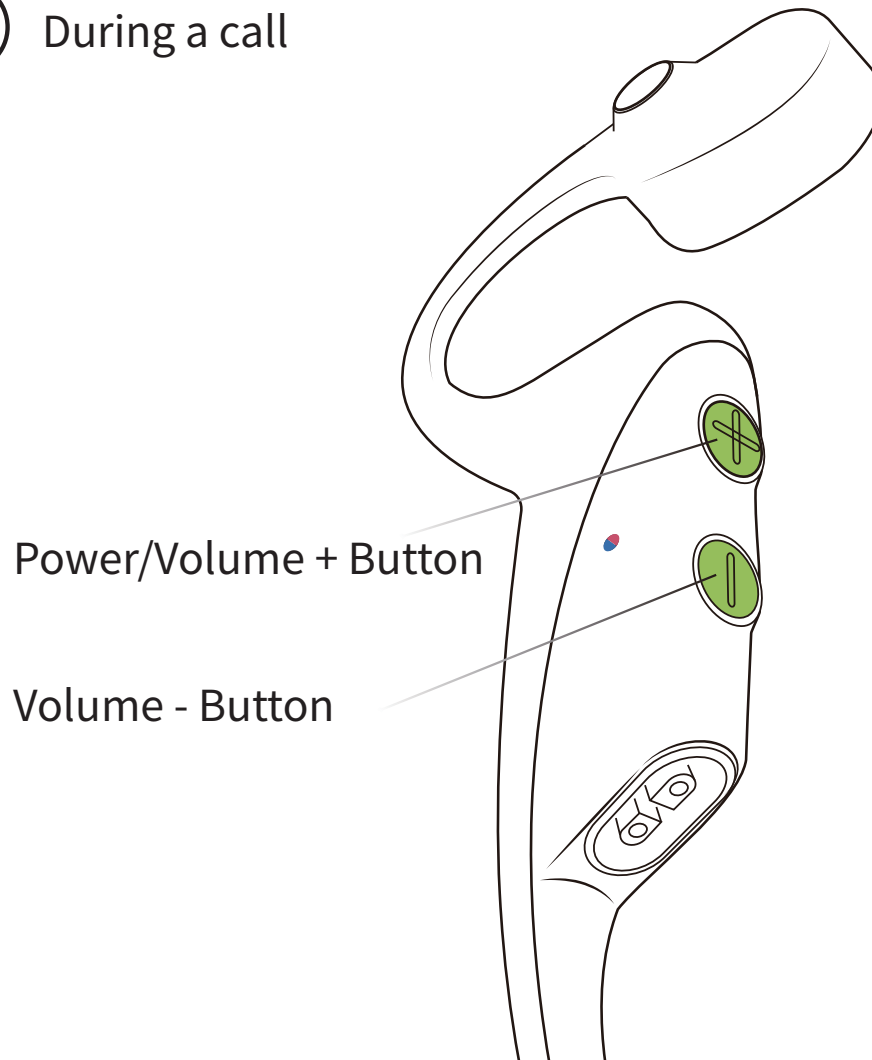

To Turn Mute On

Press and hold the Volume + and Volume - buttons while on a call until Audrey says "Mute on".

To Turn Mute Off

Press and hold the Volume + and Volume - buttons while the microphone is muted until Audrey says "Mute off".

Multifunction Button

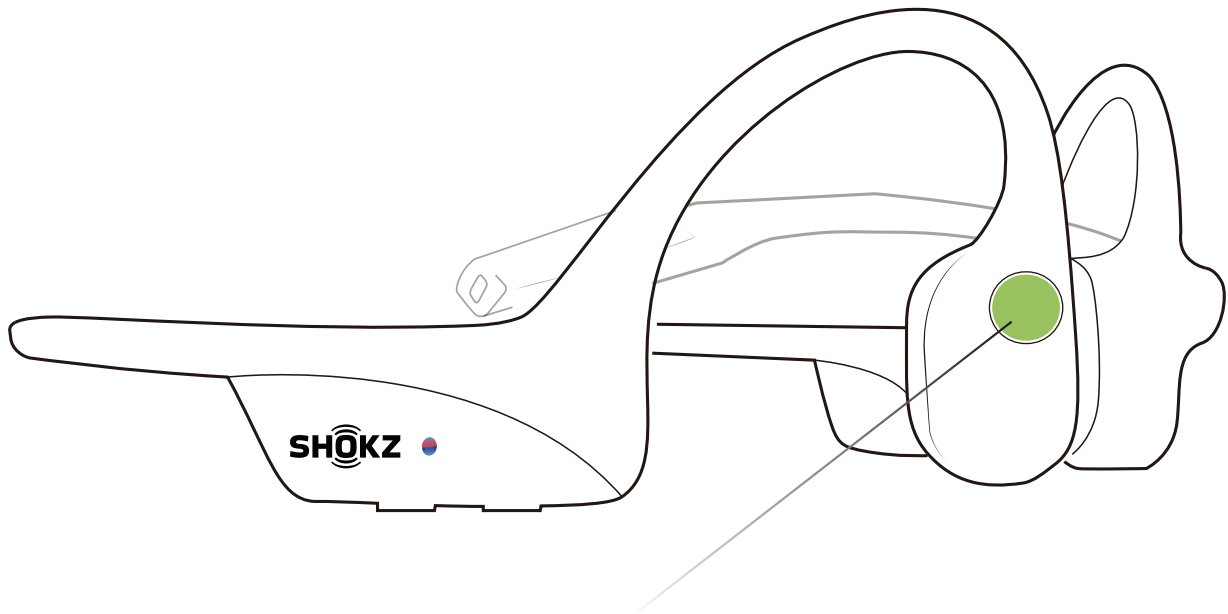

Multifunction Button

▶|| Play/pause music ●

Click once

☎ Answer call ●

Click once

▶▶ Next song ●●

Double-click while music is playing

📞 End call ●

Click once

◀◀ Previous song ●●●

Triple-click while music is playing

Multifunction Button

Play music	Click once
Pause music	Click once
Next song	Double-click while music is playing
Previous song	Triple-click while music is playing
Switch language	Double-click while pairing
Answer call	Click once
End call	Click once during a call
Answer call waiting and end current call	Press and hold for 2 seconds when receiving a second call
Ignore a call	Press and hold for 2 seconds during an incoming call
Activate voice assistant	Press and hold for 2 seconds when device is on standby
Redial last number	Double-click on standby

*Only applicable for phone calls, not online calls

Check Battery Status



Operate controls while
audio is not playing

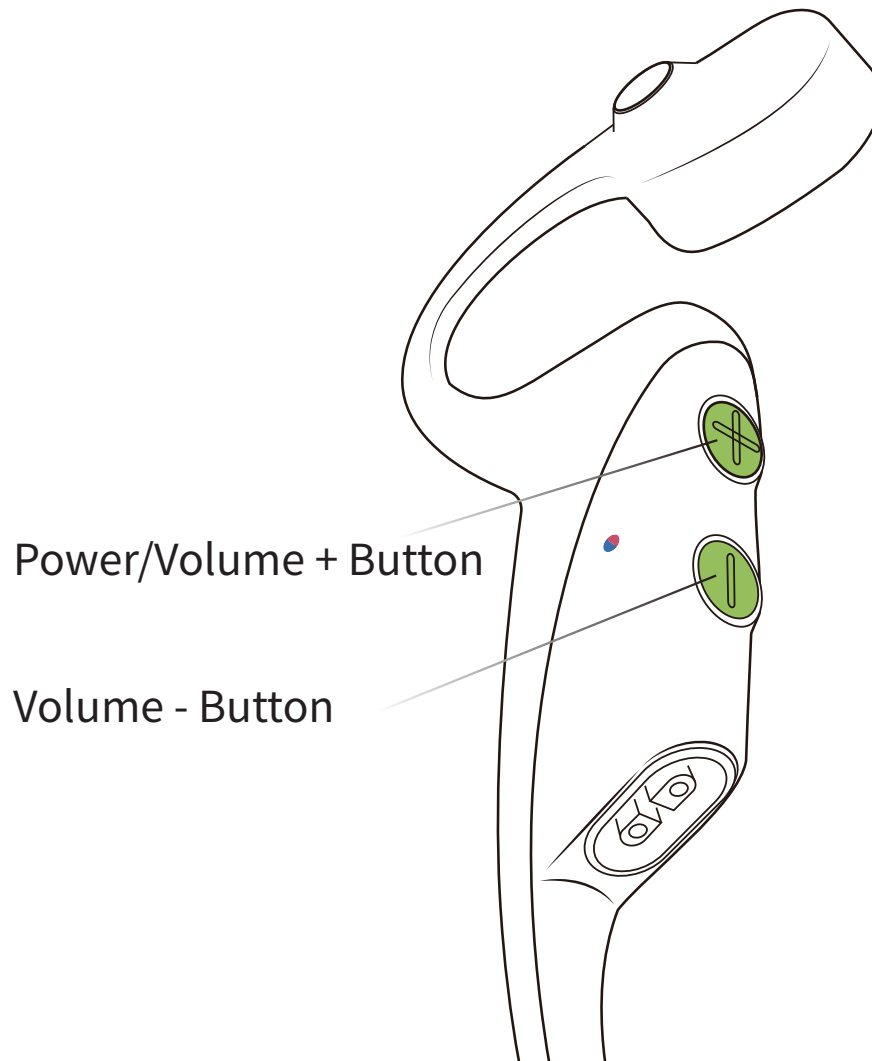

Power/Volume + Button

Volume - Button

How to check battery status:

Click the Volume + or Volume - button while music is paused,
Audrey will tell you the battery status:

* "Battery high/Battery medium/Battery low/Charge me"

Extra Features

EQ Modes



Standard Mode:

Standard listening mode with your ears open.

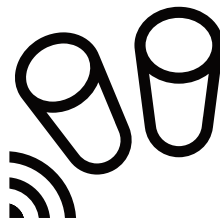

Earplug Mode:

Use earplugs with headset in noisy environments where it is safe to block out ambient noise, such as on a train or in a factory plant.

Switching EQ Modes



Operate controls while music is playing

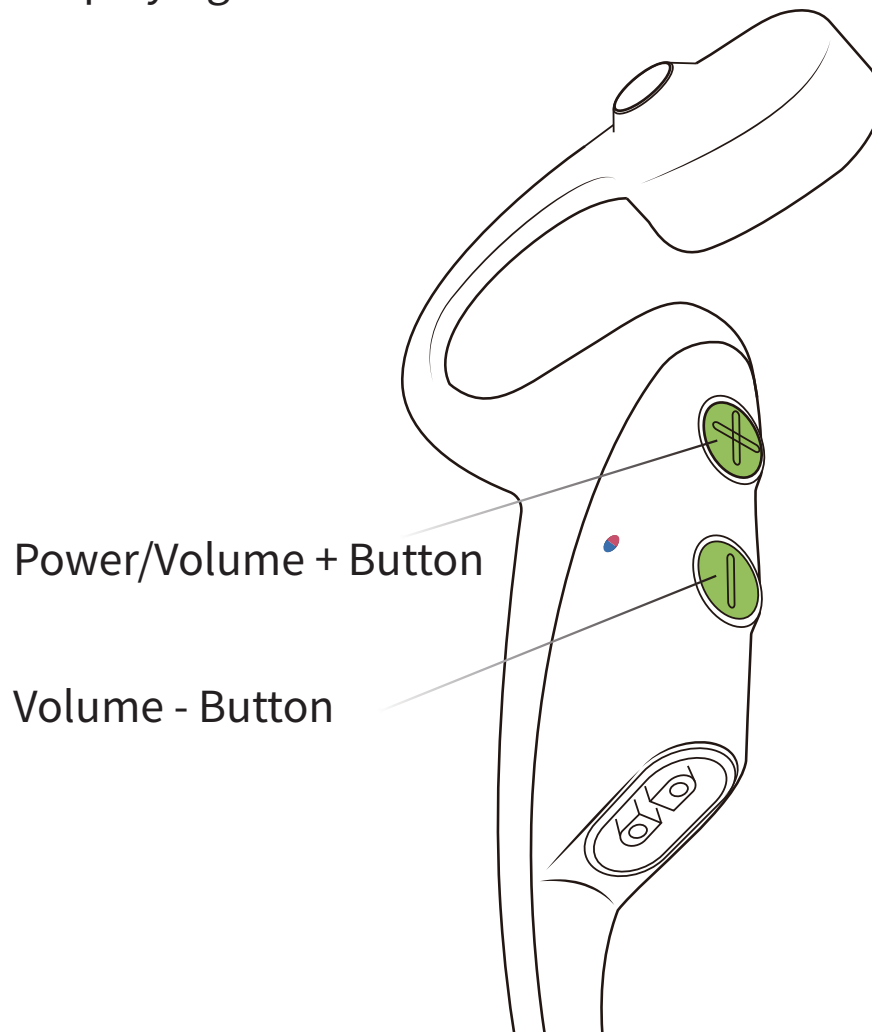

How to switch EQ mode:

Press and hold both buttons (Power/Volume + Button and Volume - Button) while music is playing until you hear a beep.

*Audrey will say: “EQ changed”

Multipoint Pairing



Pair Two Devices

Switch between two devices
seamlessly with multipoint pairing

Multipoint Pairing

OFF Operate controls with
headset powered off

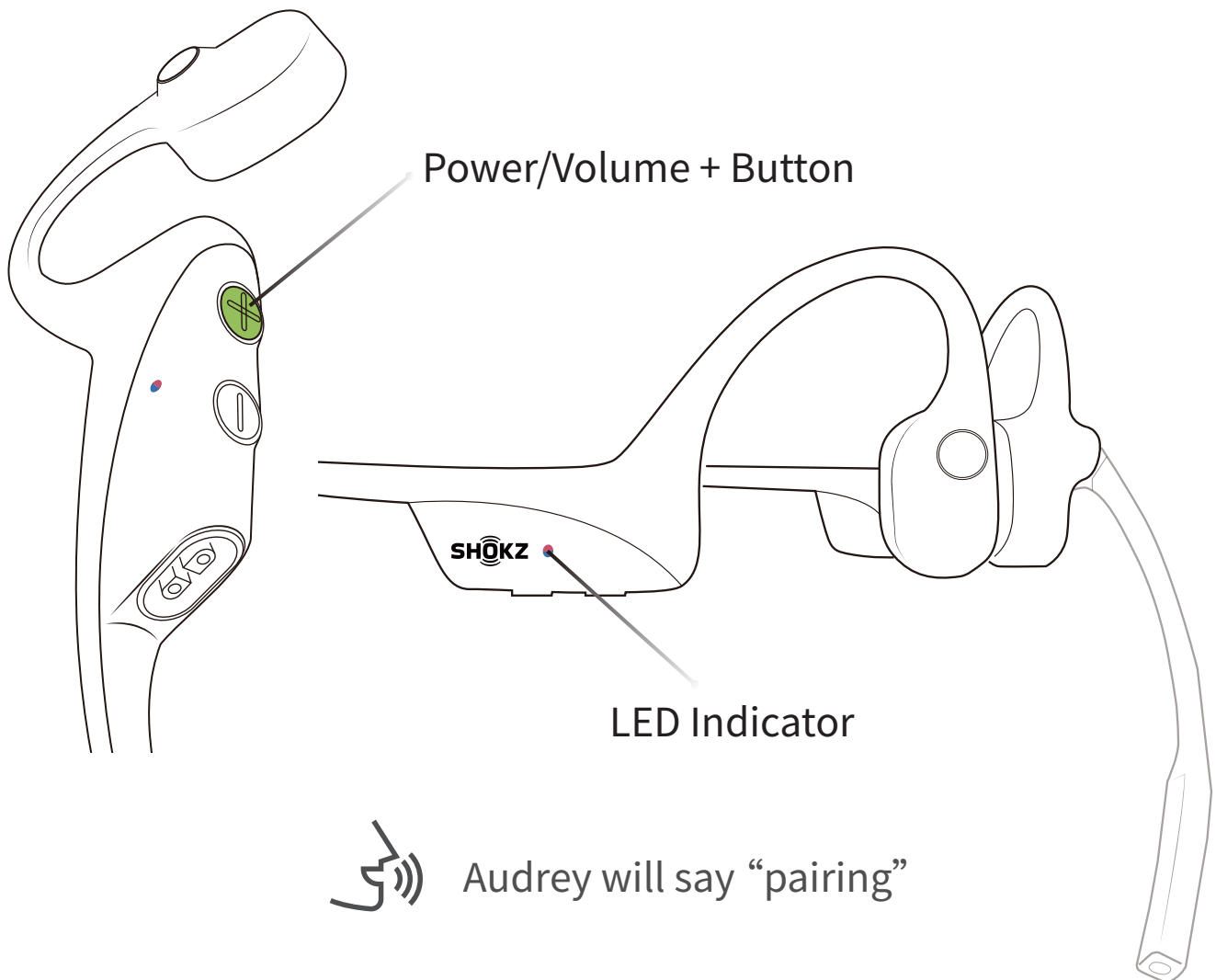

1. Start with your headset powered off.
2. Press and hold Volume + until Audrey will say "pairing" and the LED indicator flashes red and blue alternately.

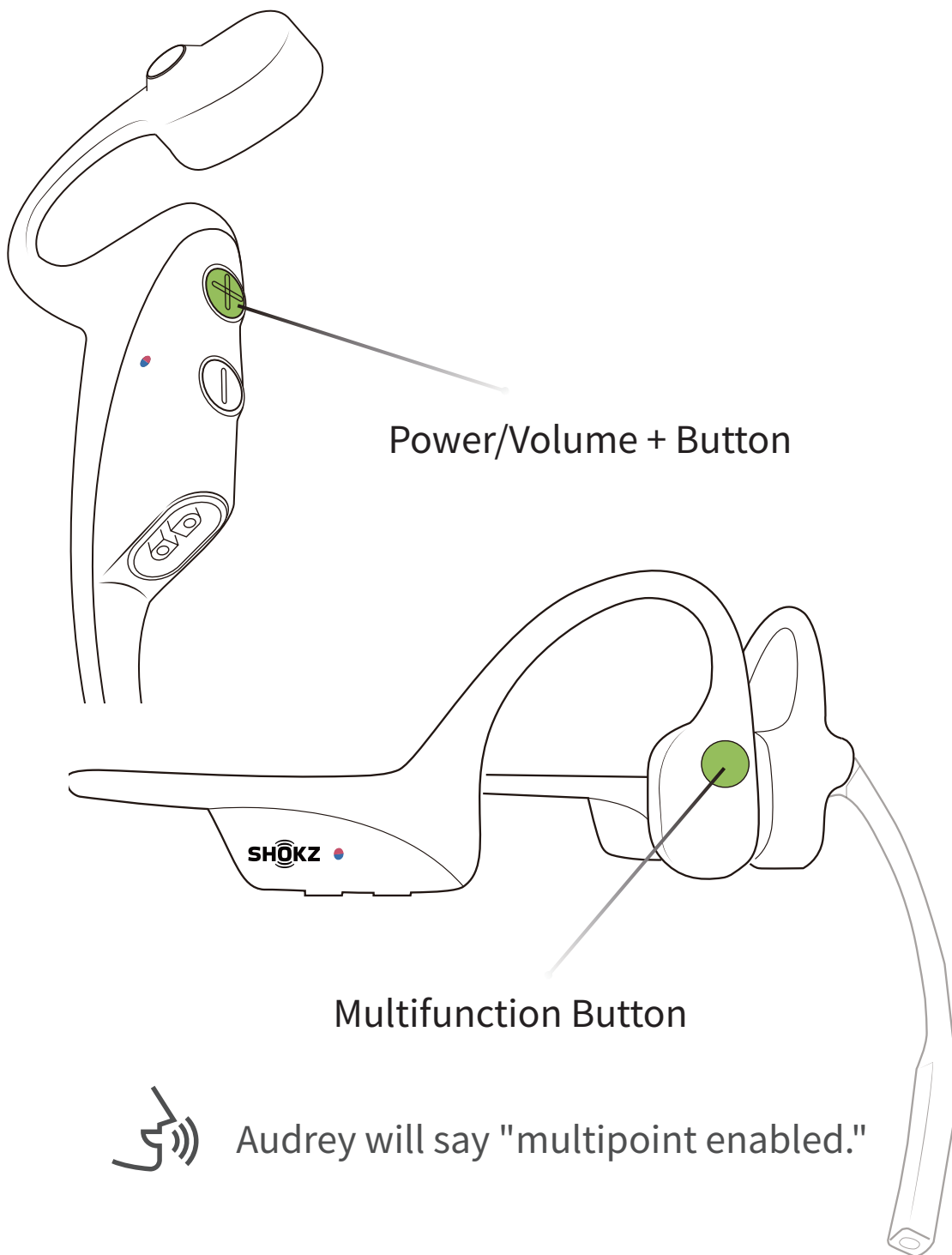

3. Press and hold the multifunction button and Volume + button until Audrey says "multipoint enabled."

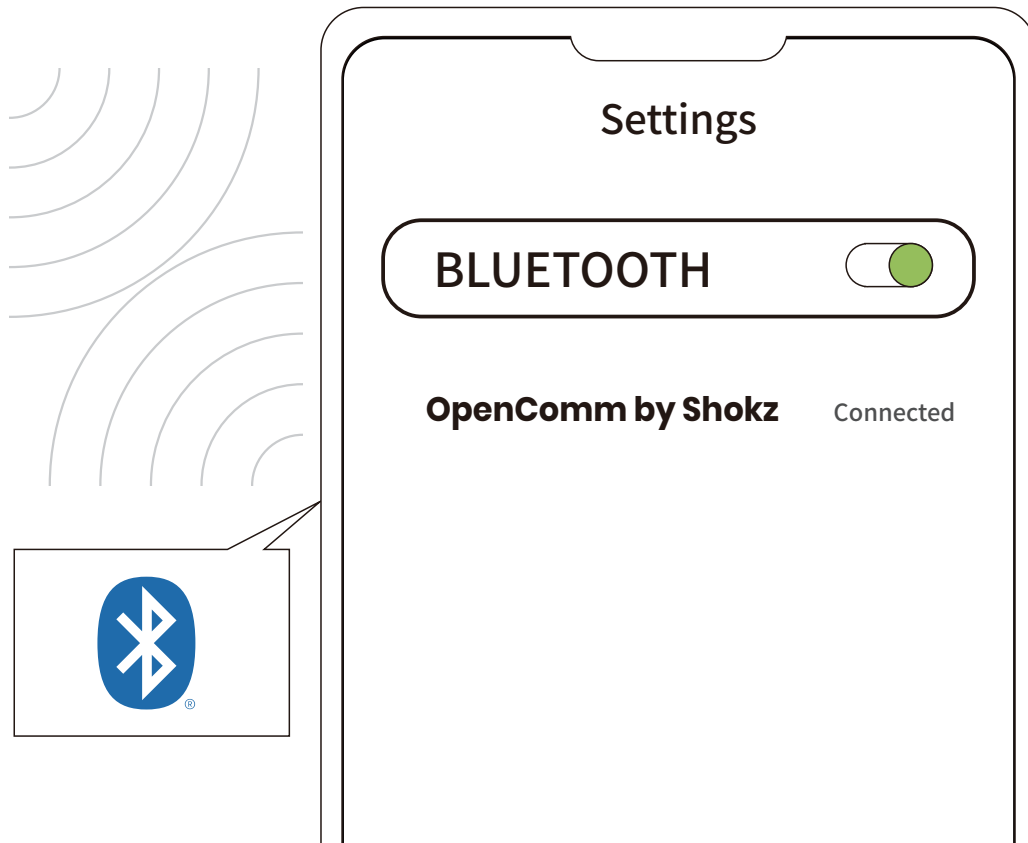

First Device



Audrey will say "connected".

4. Open first device's Bluetooth® menu and select "OpenComm by Shokz." Audrey will say "connected".

5. Turn your headset off.

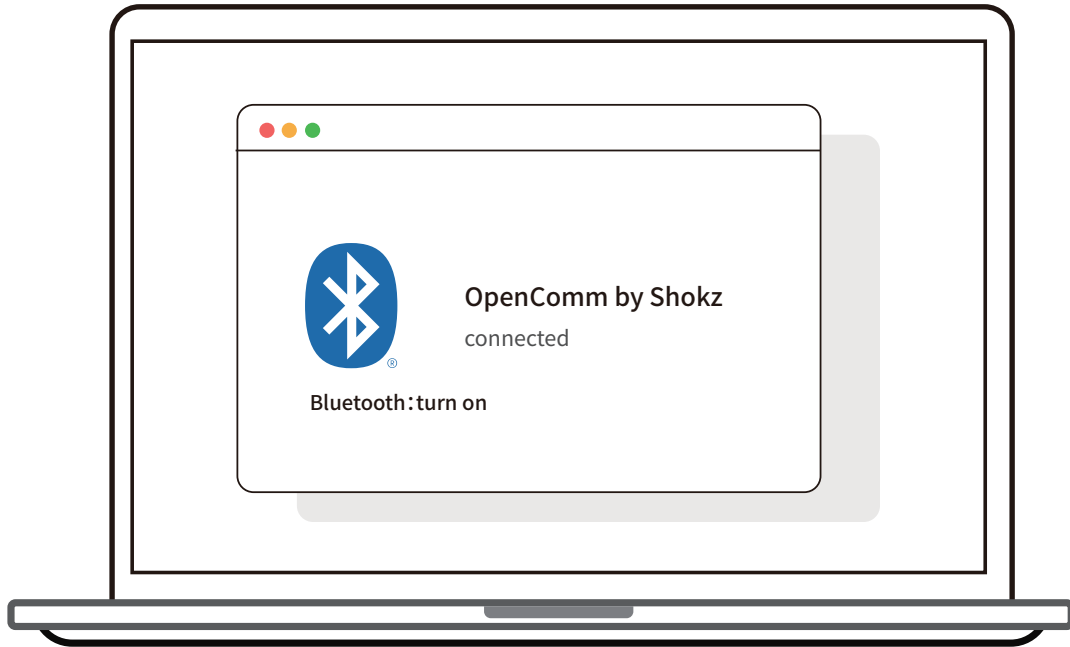

Second Device



Audrey will say "connected".

6.Re-enter pairing mode by pressing and holding Volume + until Audrey says “pairing” and the LED indicator flashes red and blue alternately.

7.Open second device's Bluetooth® menu and select "OpenComm by Shokz."Audrey will say "connected."

8.Turn your headset off.

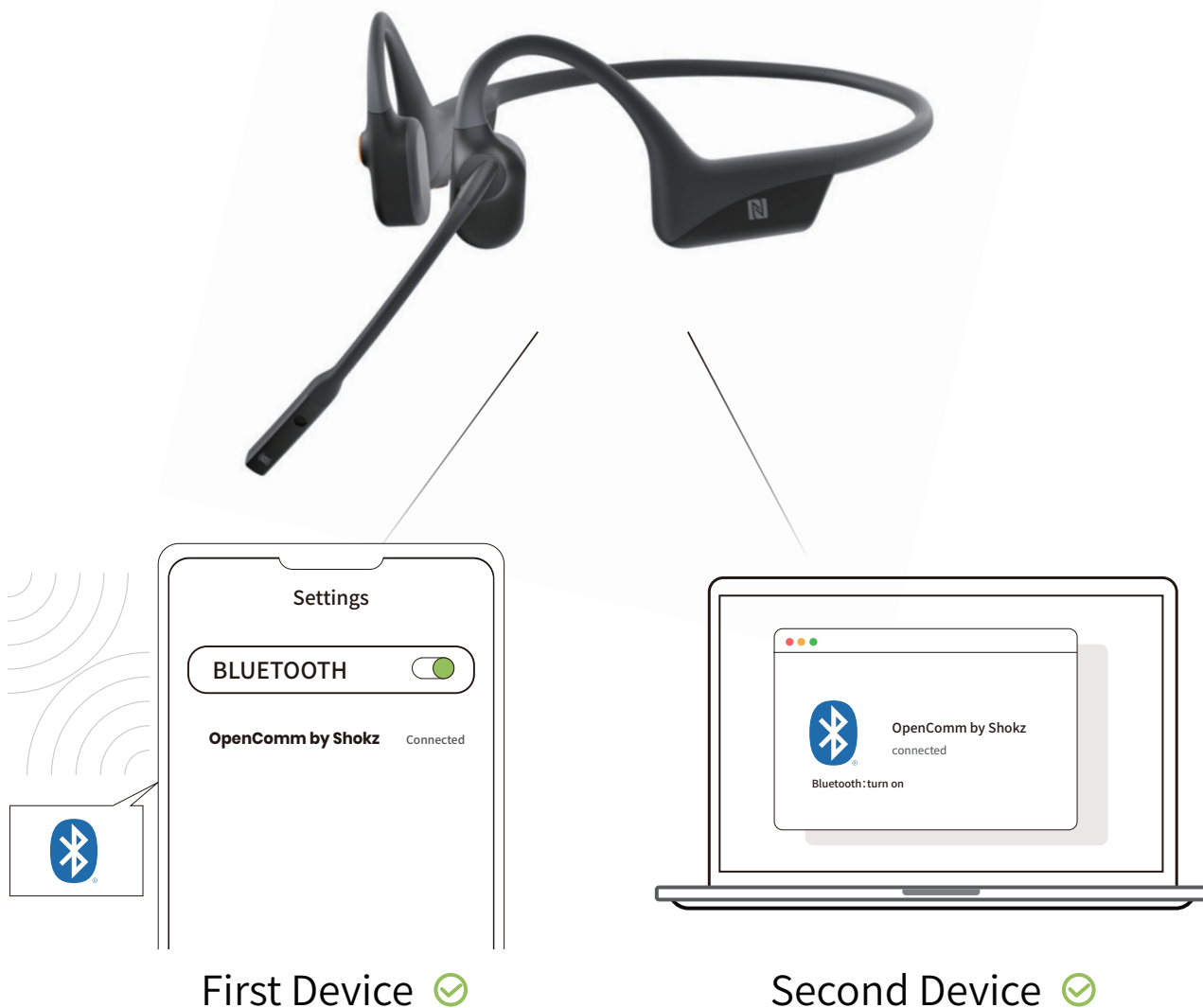

You will hear a beep, then Audrey will say “Welcome to Shokz, connected. Second device connected.”

9. Turn your headset on. Your headset is now connected to both devices.

Turn Multipoint Pairing Off

OFF Operate controls with headset powered off.

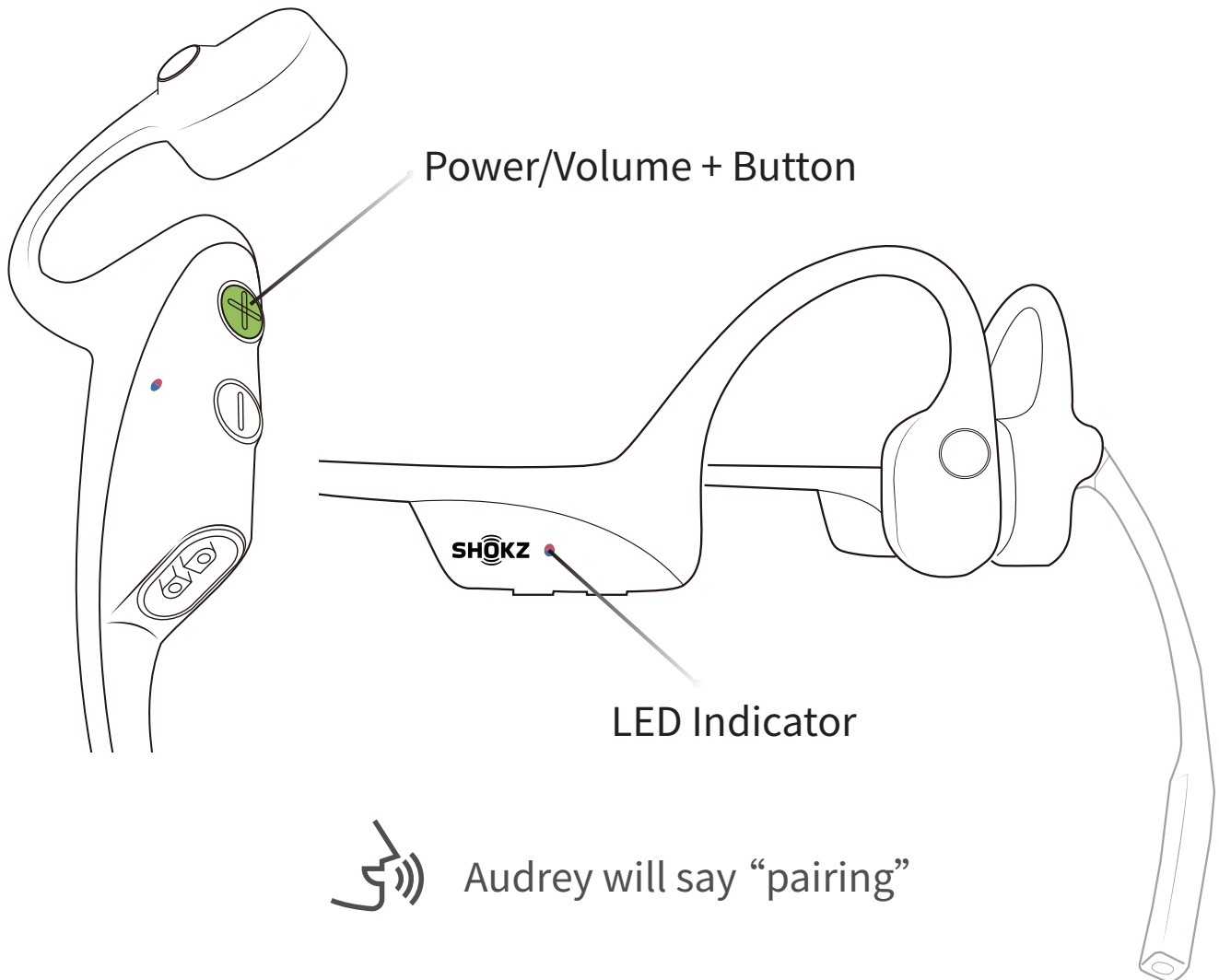

1. Start with your headset powered off.
2. Press and hold Volume + until Audrey will say “pairing” and the LED indicator flashes red and blue alternately.

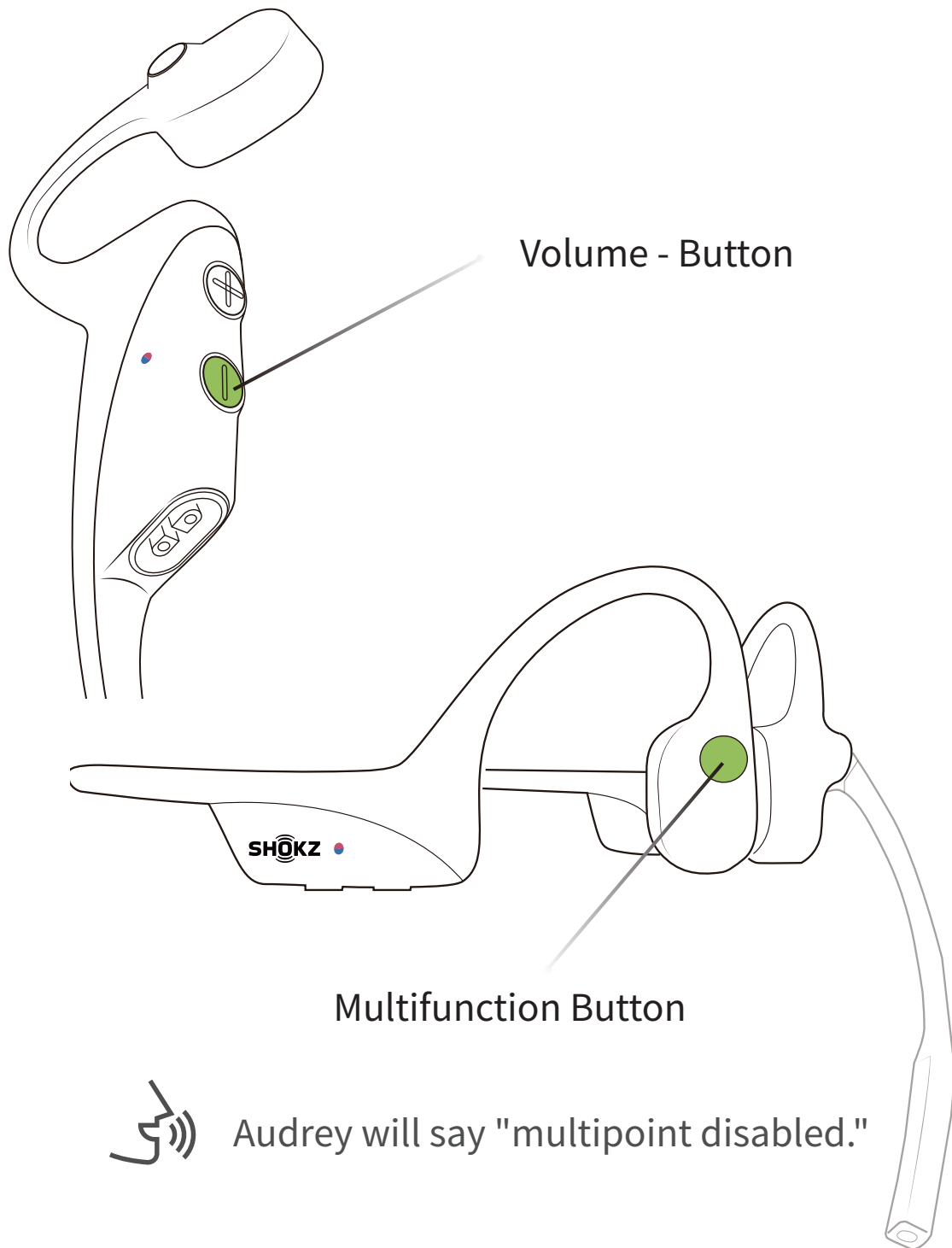

3. Press and hold the multifunction button and Volume - button until Audrey will say "multipoint disabled."

Restore Factory Settings

OFF Operate controls with headset powered off.

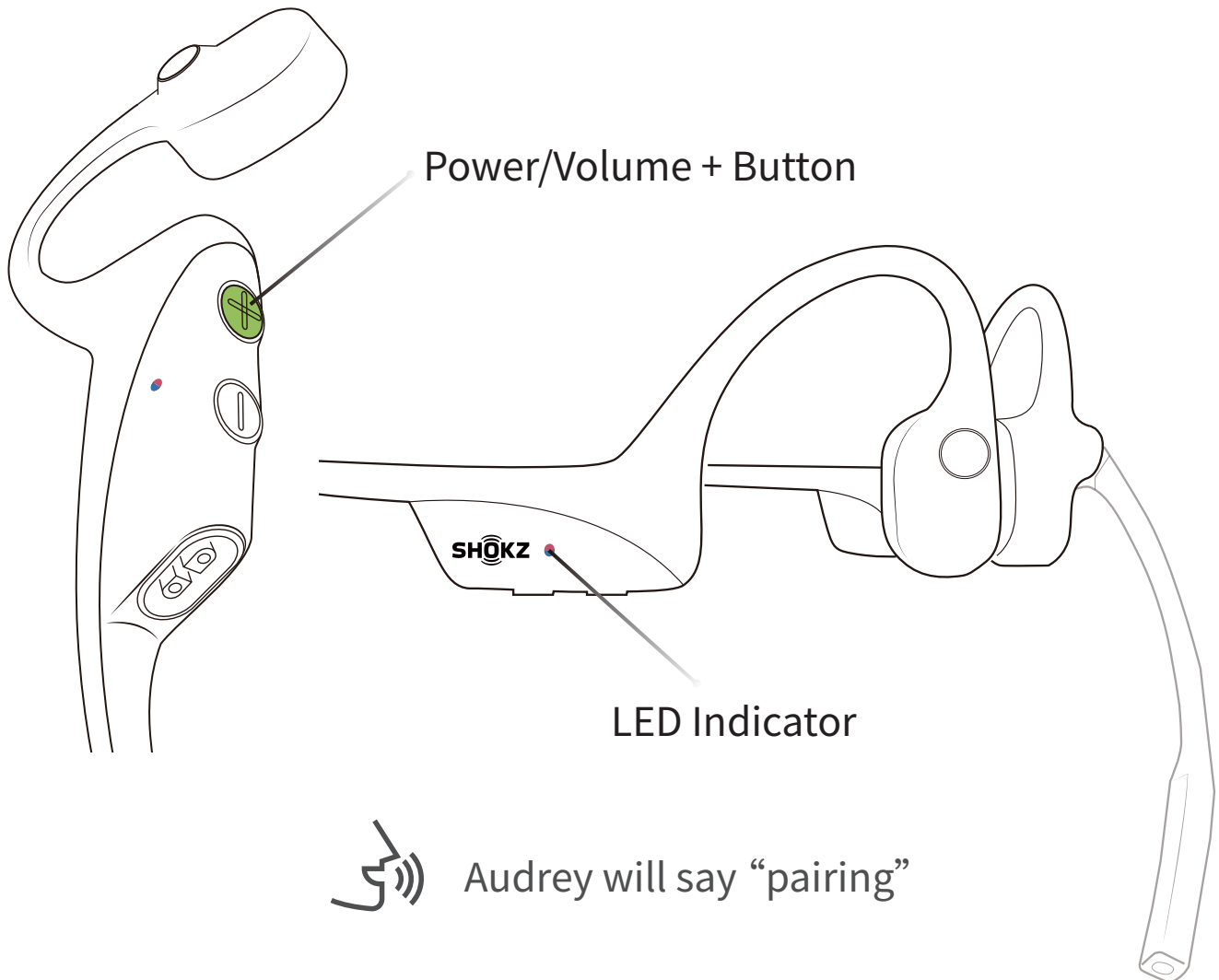

1. Start with your headset powered off.
2. Press and hold Volume + until Audrey will say “pairing” and the LED indicator flashes red and blue alternately.

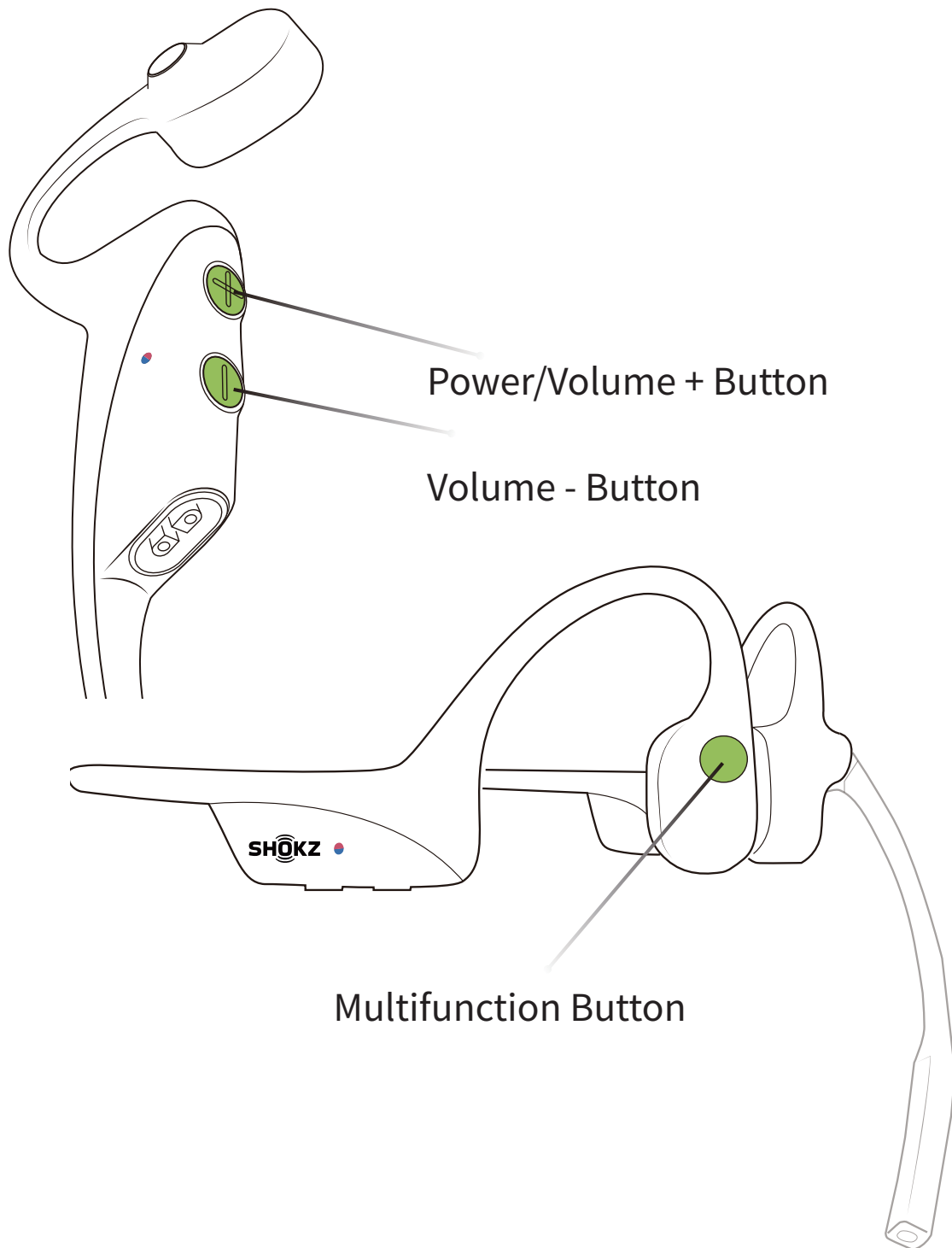

3. Press and hold the multifunction button, Volume – button and Volume + button until hear two beeps and feel the vibration.

4. Turn your headset off. OpenComm is now reset and can be re-paired to your device.

Changing Languages

Your headphones have four built-in languages:
Chinese, English, Japanese and Korean.

OFF Follow the instruction when
headset powered off

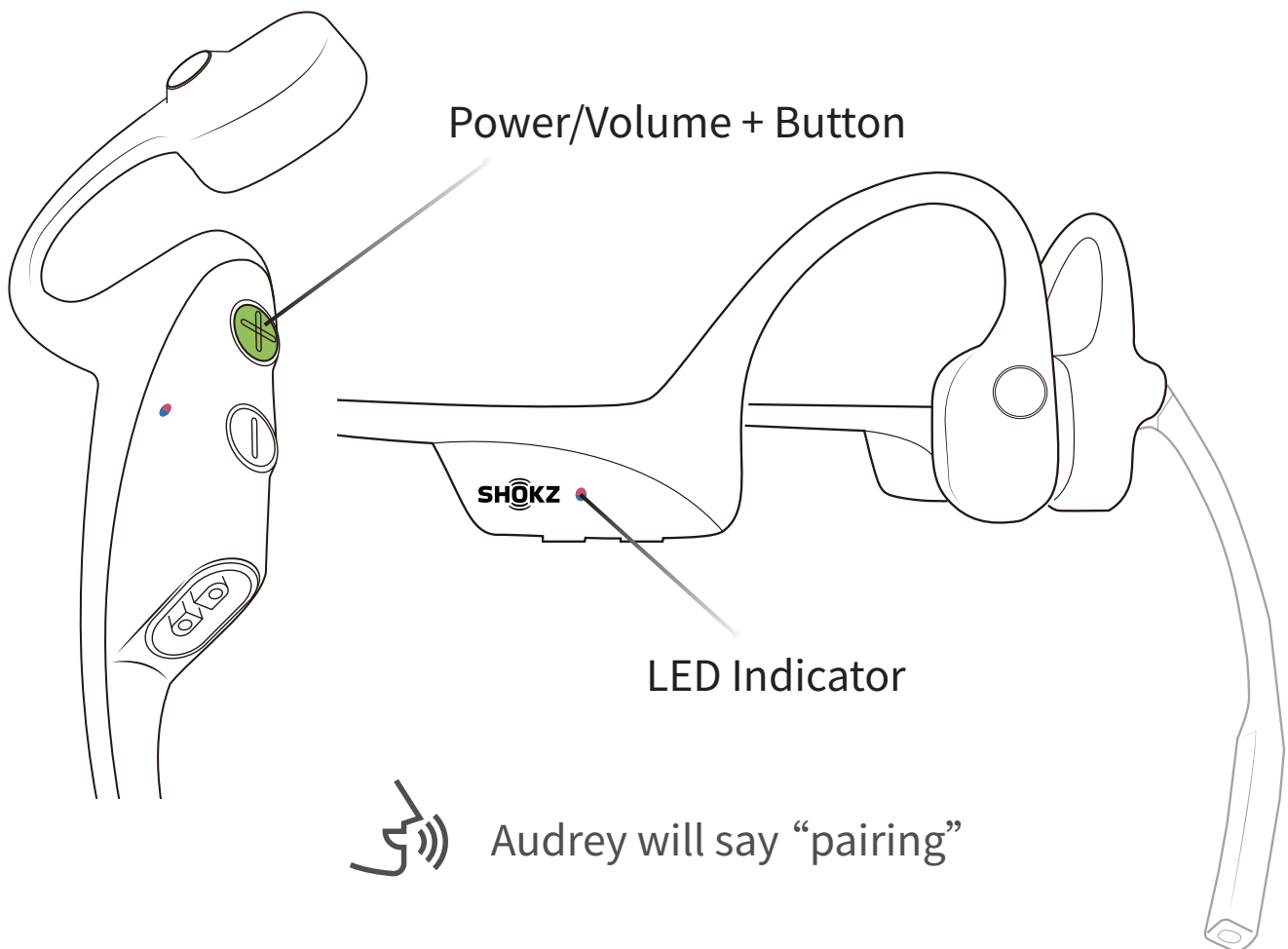

1. Start with your headset powered off.
2. Press and hold Volume + until Audrey will say “pairing” and the LED indicator flashes red and blue alternately.

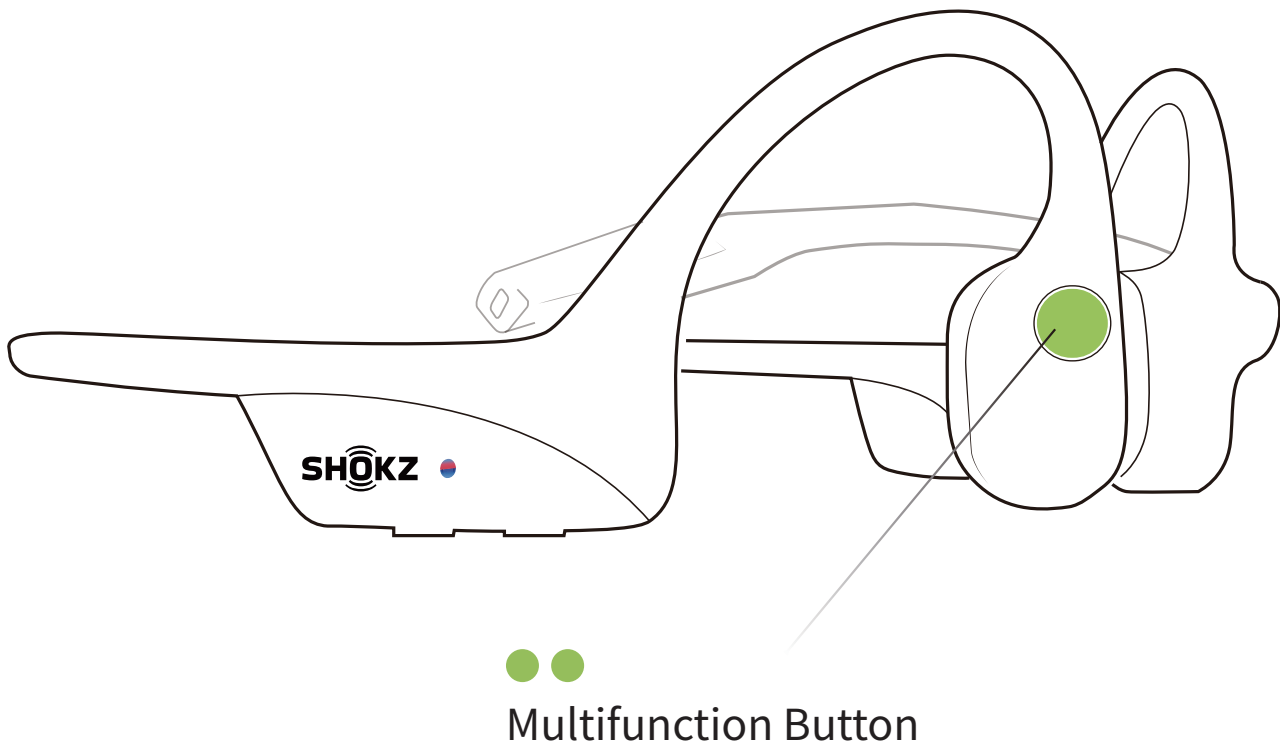

3. Double-press the multifunction button. Languages have been switched when you hear the corresponding language.

Care and Maintenance

Charging Tips

- OFF** The headset will automatically shut down when charging

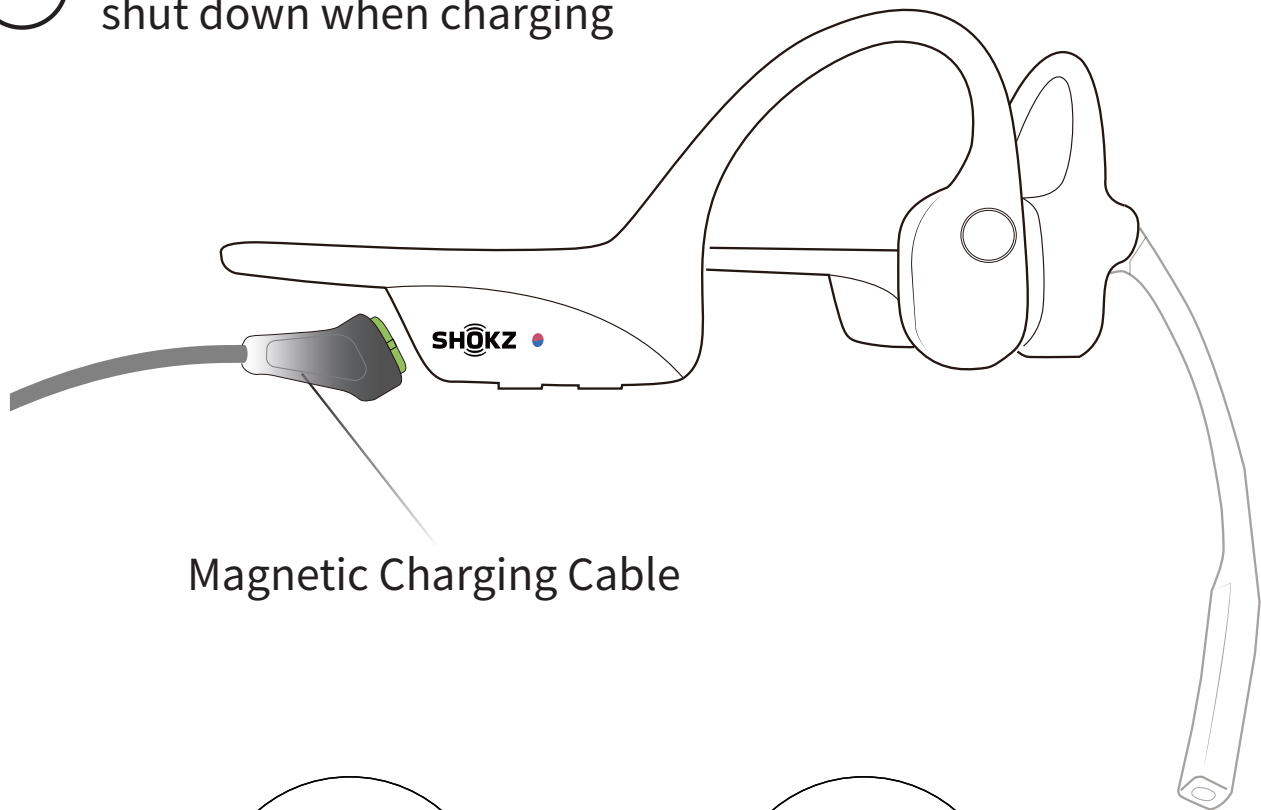

Magnetic Charging Cable

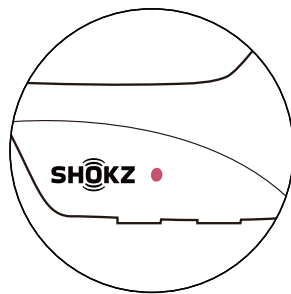

Charging



Charging Completed

When the headset is at low battery, there will be a “charge me” prompt and the red light will flash intermittently. Use the corresponding magnetic charging cable for charging.

The LED indicator will turn red during the charging process and the headset will automatically turn off. The LED indicator will turn from red to blue when charging is complete.

Moisture Detection Alert

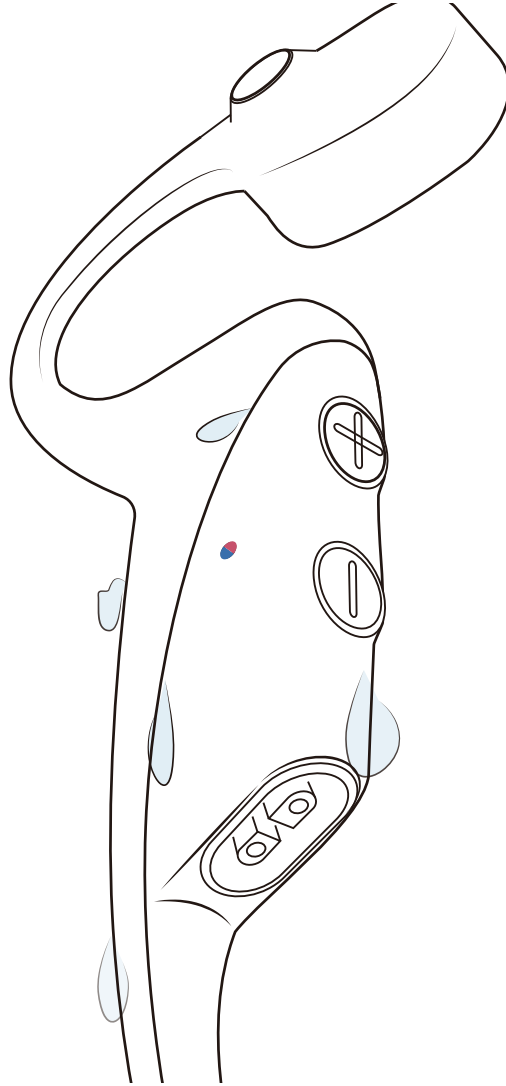

How it Works:

These headset can detect liquid such as water, sweat, or rain. If the headset this plugged into the charger while wet, the LED indicator will flash red and blue. The headset will then emit a beep. If this happens, remove the charging cable, dry them completely, then proceed with charging.

Storage and Maintenance

- Store the headset in a cool, dry place. The working temperature should be 0~45°C(32~113°F). Working in a cold/hot environment, a highly humid area, or an extremely low air pressure may reduce the battery life.
- Keep the product away from heat sources, direct sunlight, combustible gas or other liquids.
- Keeping the charging port dry before connecting to the charger will reduce the risk of damage.
- This headset is water-resistant, but is not waterproof. Please do not submerge the headset in water.
- Clean the headset with a soft dry cloth.
- Do not charge right after exercising, in case there's sweat inside the charging port, which could lead to circuit burning while charging.
- After storage for a long period, please charge the headset before using again.

A circular icon containing the letters "BC".

Note

Design and specification are subject to change without notice. For the most up-to-date product information, please visit <https://shokz.com>.

Warning

To avoid the risk of explosion, fire, or leakage from toxic chemicals, please do not disassemble the product or replace, deform, or mutilate the battery.

Warranty

Your headset are covered by a warranty.

Visit our website at <https://shokz.com/pages/warranty-landing> for details of the limited warranty.

*Failure to register will not affect your limited warranty rights.

Troubleshooting



If you have any trouble or problems, please visit
<https://shokz.com/pages/faq>
for more support!

What's in the Box



OpenComm
Box

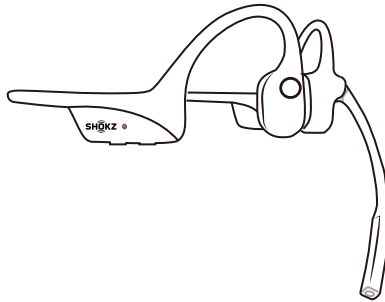

OpenComm
headset



OpenComm
Package



Magnetic
Charging Cable

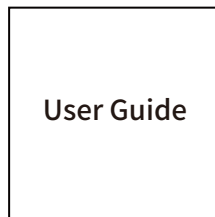

OpenComm
User Guide

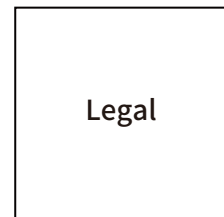

OpenComm
Legal Statement

If any part of your product is damaged or missing, do not use it. Contact authorized Shokz dealer or Shokz customer service.

*Please note that the packaging envelope may vary depending on the sales region.

Regulatory and Legal Information

FCC Caution

Any changes or modifications not expressly approved by the party responsible for compliance could void the user's authority to operate the equipment. This device complies with Part 15 of the FCC Rules.

Operation is subject to the following two conditions:

- (1) this device may not cause harmful interference, and
- (2) this device must accept any interference received, including interference that may cause undesired operation.

FCC Statement

This equipment has been tested and found to comply with the limits for a Class B digital device, pursuant to part 15 of the FCC Rules.

These limits are designed to provide reasonable protection against harmful interference in a residential installation. This equipment generates, uses and can radiate radio frequency energy and, if not installed and used in accordance with the instructions, may cause harmful interference to radio communications. However, there is no guarantee that interference will not occur in a particular installation.

If this equipment does cause harmful interference to radio or television reception, which can be determined by turning the equipment off and on, the user is encouraged to try to correct the interference by one or more of the following measures:

- Reorient or relocate the receiving antenna.
- Increase the separation between the equipment and receiver.
- Connect the equipment into an outlet on a circuit different from that to which the receiver is connected.
- Consult the dealer or an experienced radio/TV technician for help.

This equipment complies with FCC/IC radiation exposure limits set forth for an uncontrolled environment and meets the FCC radio frequency (RF) Exposure Guidelines and RSS-102 of the IC radio frequency (RF) Exposure rules. This equipment has very low levels of RF energy that is deemed to comply without testing of specific absorption rate (SAR).

Responsible party (contact for FCC matters only):

AfterShokz LLC.

3200 Gracie Kiltz Lane, Suite 400 Austin, TX 78758 USA

<https://shokz.com>

Industry Canada

This device complies with Industry Canada licence-exempt RSS standard(s): Operation is subject to the following Two conditions: (1) this device may not cause interference, and (2) this device must accept any interference, including interference that may cause undesired operation of the device.

CE Declaration of Conformity

Shokz Holding Limited hereby declares that this product is in compliance with the essential requirements and other relevant provisions of Directive 2014/53/EU and all other applicable EU Directive requirements. The complete declaration of conformity can be found at:

<https://shokz.com/pages/policies>. Shokz' s EU representative is AfterShokz Euro B.V., Schipholweg 103, 2316XC Leiden, Netherlands.

Frequency Range	Max. Transmit Power
2400-2483.5MHz	8dBm(EIRP)



UK Declaration of Conformity

Shokz Holding Limited hereby declares that this product is in compliance with the essential requirements and all other applicable United Kingdom' s regulations. The complete declaration of conformity can be found at: <https://shokz.com/pages/policies>.

Shokz' s authorised representative in the UK is Pinpoint Consumer Electronics Ltd., Unit 35, Meridian House, Road One, Winsford Industrial Estate, Winsford, Cheshire CW7 3QG.



WEEE Declaration of Conformity

This WEEE logo means that this product must not be discarded

as household waste, and should be delivered to an appropriate collection facility for recycling. Proper disposal and recycling helps protect natural resources, human health and the environment. For more information on disposal and recycling of this product, contact your local municipality, disposal service, or the shop where you bought this product.



Australia/New Zealand



Singapore

**Complies with
IMDA Standards
DA106614**

Philippines



SHOKZ